

# PEYCO SOUTHWEST REALTY, INC.

---

7000 South Cooper Street ♦ Arlington, Texas 76001-6720 ♦ Metro (817) 467-6803 ♦ Fax (817) 465-7464

## 42,098 Square Foot of Warehouse Space For Lease



Building Specifications

5600 Midway Rd., Haltom City, TX 76117 is located approximately ¼ mile north of Hwy 121. Take Carson St. Exit north, then west on Midway Rd. Building is located on south side of the street.

- The 55,057 SF building is concrete tilt wall construction and sits on 5.75 acres of land with plenty of room for outside storage.
- The building is equipped with heavy industrial power
- The warehouse area is accessed by 3 docks and 1 Grade level doors (14' x 12')
- The building has clear heights ranging from 20' to 26'
- The office area consists of approximately 14,000 SF that can be adjusted according to prospective tenant's needs.
- Lease Rate is \$4.25 SF NNN with a 5-7 year term.
- For Additional information or to arrange an appointment for showing, contact Jim Maibach or Blake Martensen of Peyco Southwest Realty, Inc. 817-467-6803. Or e-mail us at [jmaibach@peycosouthwest.com](mailto:jmaibach@peycosouthwest.com) or [blake@peycosouthwest.com](mailto:blake@peycosouthwest.com). Our website can be viewed at [www.peycosouthwest.com](http://www.peycosouthwest.com).

**Information furnished is from sources deemed reliable. While we do not doubt its accuracy, we have not verified it and make no guarantee, warranty or representation about it. It is your responsibility to independently confirm its accuracy and completeness. Any projections, opinions, assumptions, or estimates used for are for example only and do not represent the current or future performance of the property. The value of this transaction to you depends on tax and other factors which should be evaluated by your tax, financial, and legal advisors. You and your advisors should conduct a careful, independent investigation of the property to determine to your satisfaction the suitability of the property for your needs. Information is subject to change in price, errors and omissions, prior sales or withdrawal without notice, and to any special listing conditions imposed by out principals.**



Loose  
12,989 SF

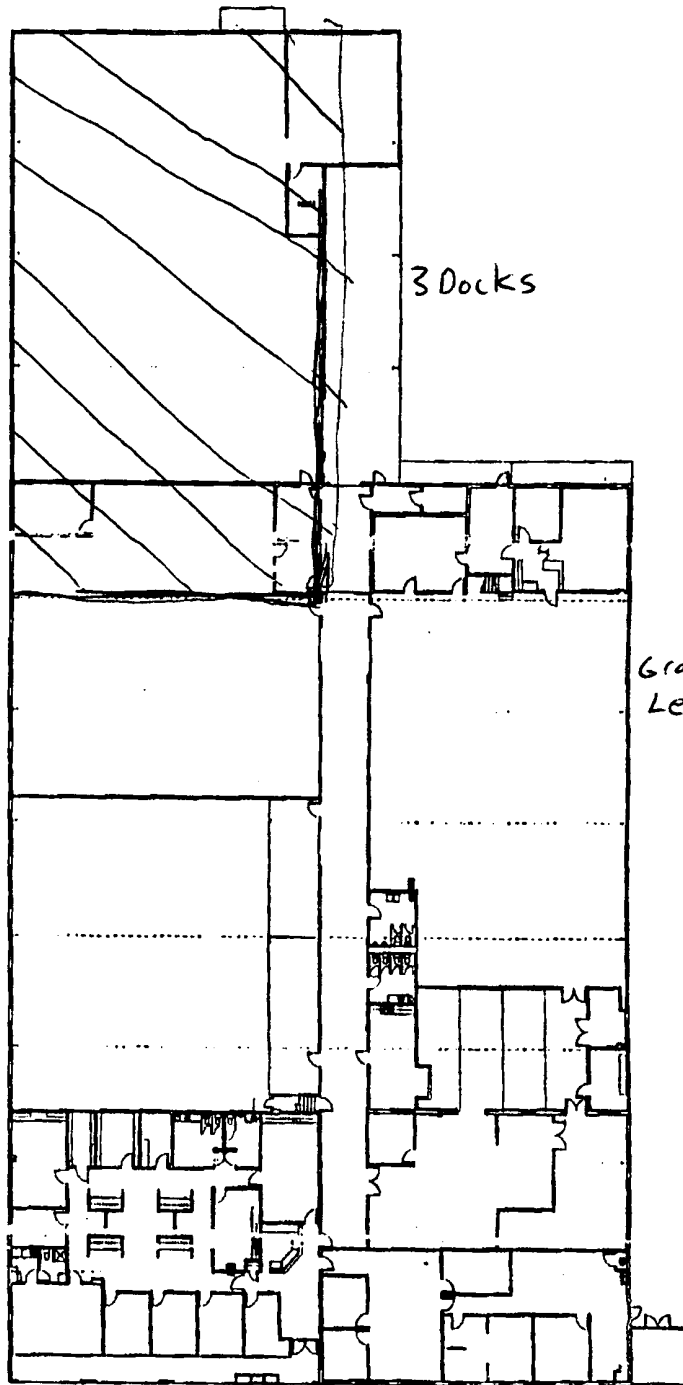

5600 Midway Drive/Haltom City, TX

1" = 30'  
11 NOV 1999

AS-BUILT FLOOR PLAN

MCE1111  
1999 © Muller Design Associates